

Product Code: C04001

1. INSTALLATION

BATTERY

Remove the battery holder from the back of the timer and insert **4x AA Alkaline batteries**. securely replace the battery holder back into the unit to ensure water resistance.

Note: Do not use rechargeable batteries.

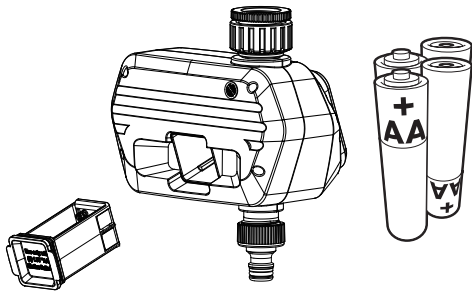

INSTALLATION

Attach the timer to an outside tap and turn on the water. Leave the water on while the tap timer is attached.

Note: For ease of programming we suggest programming the timer before attaching it to the tap.

2. SETTING CURRENT TIME & DAY



- The 'Set Time' mode is automatically selected when the timer is turned on (an arrow will be pointing to 'Set Time'). The current time & day must be set for the timer to operate a schedule.
- Press **←** or **→** to select the current day. Press **OK** to save the selected day.
- The time will now be flashing. Hold down **→** to adjust the minutes & hours. Holding **→** will automatically run through the 24 hours changing the time from AM to PM.
- Press **OK** to save the set time.

3. SETTING THE WATERING DAYS

Press **↻** to change to the next mode.

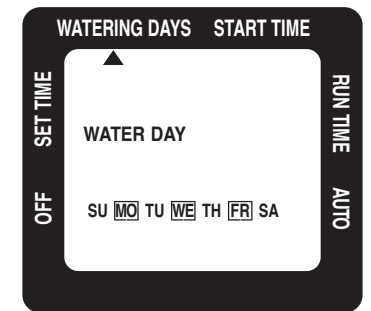

'Water Day' is where you set the days you want the tap timer to water.

- To select the watering day(s) press **→** to move **□**
- When **□** is over the selected day press **OK**. To select additional days use **←** or **→** then press **OK** to save.

Notes:

- The days with **□** are the days the timer will water.
- To de-select a day press **→** until it is flashing then press **OK**.

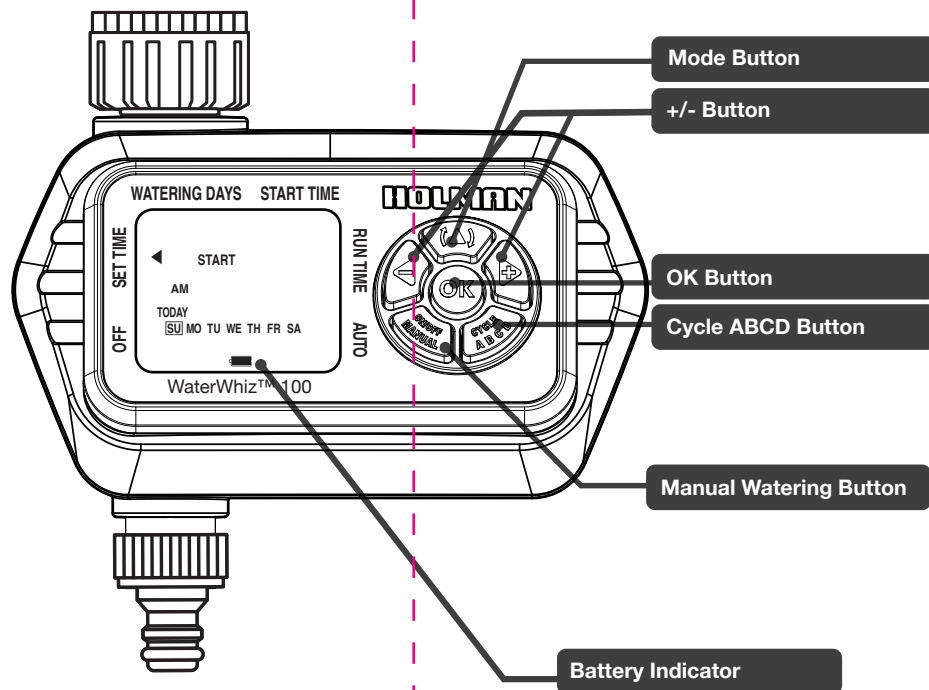

3.1 SETTING THE WATERING DAYS

INTERVAL SCHEDULING



Interval scheduling allows an interval program between (1 to 7 days). Setting a schedule for every 3 days would mean that the tap timer will run every 3 days.

- Press **→** until the end of (SA) to get to interval watering.
- Press **←** or **→** to adjust the interval. Press **OK** to save.

4. SETTING THE START TIME

Press **↻** to change to the next mode.

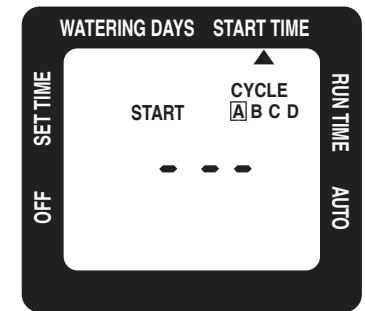

'Start Time' is the time of day that the tap timer will begin watering. You can set up to 4 cycles (start times).

- Press **→** to set the first start time on cycle A. Press **←** or **→** to adjust the time. Press **OK** to save.
- Press **[CYCLE A B C D]** to set another start time and use **←** or **→** to adjust the time.

5. SETTING THE RUN TIME

Press to change to the next mode.

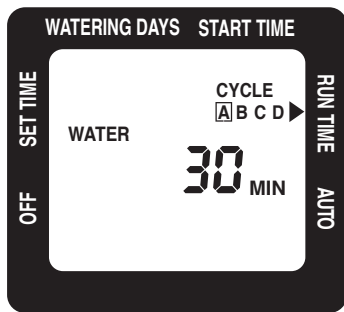

'Run Time' sets the length of time that the cycle will water for. You can set a different run time per cycle.

- Cycle A is automatically selected. Adjust the run time for cycle A using or . Press to save.
- Press to select the other cycles and repeat the above step.

Note: Press after the programming of every run time to save the schedule.

6. AUTO MODE

Press to change to the next mode.



The watering schedule will only operate when the timer is in Auto mode.

- If the timer is not in Auto mode press until the arrow is pointed to AUTO.
- The screen display will alternate between the current time and the next start time.

Note: Ensure after scheduling that the timer is left on AUTO mode.

7. OFF MODE

Press to change to OFF mode.



'OFF' mode is used to stop watering for an extended period of time. Press until the arrow is pointed to 'OFF'.

- The screen will display OFF in this mode and the timer will not water automatically while in this mode.

To start the automatic program again press until the arrow is pointed to AUTO. The program will begin watering at the next scheduled start time.

Note: In the "OFF" mode the timer will still maintain the timer programs.

8. MANUAL WATERING MODE

The in the display should be in the "AUTO" position



- Begin manual watering by pressing .
- Press or to adjust the manual run time.
- Press to begin the manual watering.
- The valve will automatically close after the scheduled time and the minutes will return back to zero.

8. MANUAL WATERING MODE CONT.

Note: To end the manual watering early press . If you end the watering early the timer will remember the minutes remaining. The remaining time will automatically begin the next time you enter manual mode. To adjust the remaining time, enter manual mode and adjust the minutes using or .

9. RESETTING THE TIMER

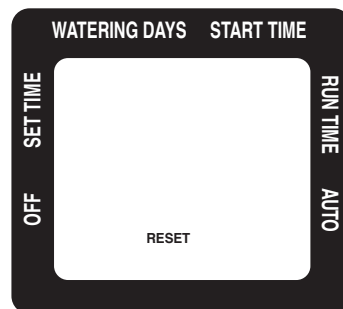

- Press and hold for 5 seconds to erase all settings in the timer and it will return to the original factory settings. The screen will display RESET.

Note: All programming will be lost when the timer is reset.

- Resetting the Tap Timer changes the clock between 12 hour format and 24 hour format. If you reset the timer and it is in 24 hour format reset the timer again. 'AM' on the display means the timer will display the 12 hour format.

10. TROUBLE SHOOTING / TIPS

- The black arrow on the side indicates the mode you are scheduling in.

• When switching from START TIME to RUN TIME the cycle last selected in START TIME will automatically be selected in RUN TIME. To change the cycle press .

- If the mode automatically jumps to AUTO it means you have not scheduled either WATERING DAYS or START TIME. Press to go back and schedule the modes.

WARNING

Do not install near any electrical outputs. Severe electrical shock could result if water is sprayed into the outlets or sources of electrical current. Do not use water more than 46°C (115°F). Do not use when the ambient air temperature is less than 4.5°C (40°F). When not in use, remove batteries, drain and store indoors away from freezing temperatures.

Operating Pressure: Min - 70kPa Max - 800kPa
Flow Rate: Up to 28L/min per valve at 250kPa.

HOLMAN INDUSTRIES
11 WALTERS DRIVE
OSBORNE PARK
PERTH 6017
WESTERN AUSTRALIA

1300 716 188