

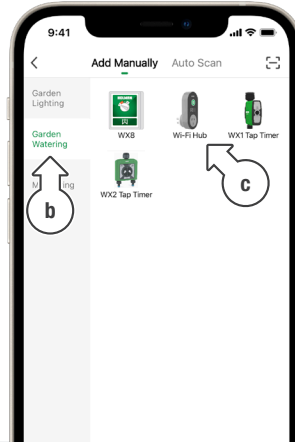

ADDING YOUR WI-FI HUB TO HOLMAN HOME USING AP MODE

1. Plug your **Wi-Fi Hub** into a power source near your Wi-Fi router
2. Open **Holman Home** and add a new device by tapping **+** [a] on the **HOME** screen
3. Tap **GARDEN WATERING** [b] and choose **Wi-Fi HUB** [c]

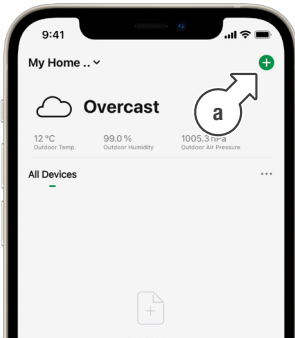

4. Enter your Wi-Fi network [d] and password [e], then tap **NEXT** [f]

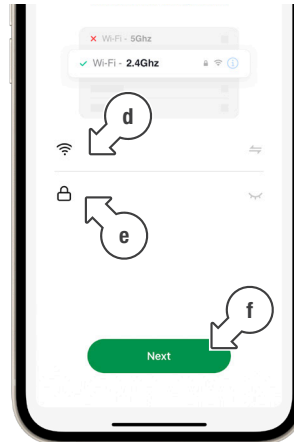

5. On the following screen, tap **EZ MODE** [g]
6. From the drop-down menu, tap **AP MODE** [h]

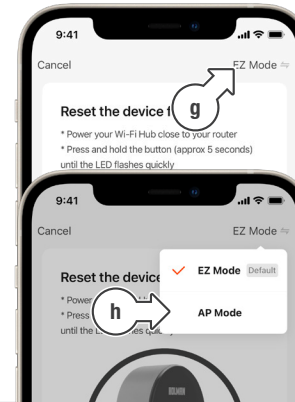

7. Reset the **Wi-Fi Hub** as per the instructions provided on-screen [i]
8. Once the **Wi-Fi Hub** is flashing accordingly, check the LED confirmation toggle [j] and tap **NEXT** [k]

i The Wi-Fi Hub has three flashing modes:

- Fast flash
- Slow flash
- Slow long blink

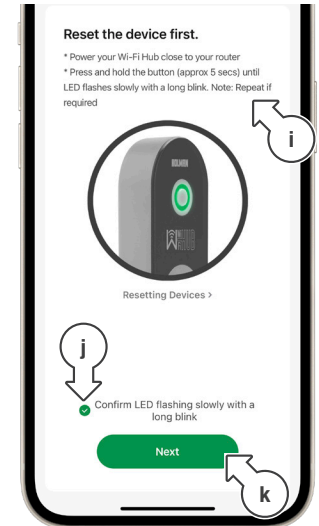

9. On the following screen, tap **GO TO CONNECT** [l]

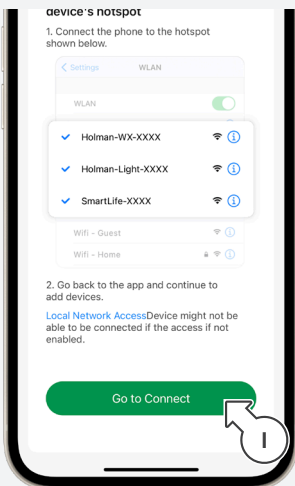

10. **iOS only:** If redirected to **SETTINGS**, tap **Wi-Fi** [m]

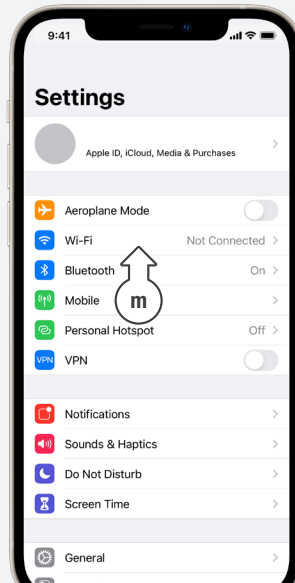

11. **iOS only:** Tap **Holman-WX-XXXX** [n] and wait until the network is connected

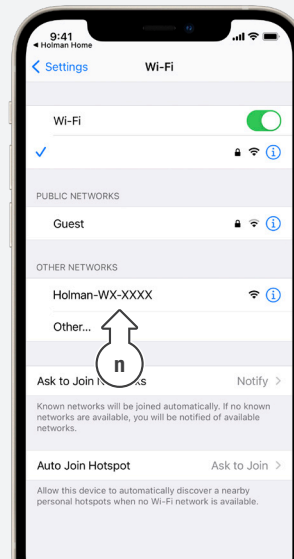

12. **Android only:** Tap the **Holman-WX-XXXX** [o] and wait until the network is connected

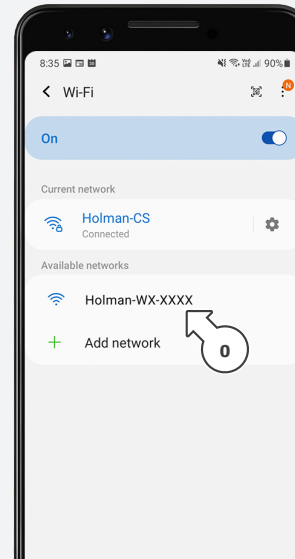

i **iOS or Android:** If the **Holman-WX-XXXX** does not show in your Wi-Fi settings, try the following:

- ✔ Disable Wi-Fi on your smartphone, wait a few moments and turn Wi-Fi back on
- ✔ You may need to reset your **Wi-Fi Hub** again; Hold the button for approximately 5 seconds to change to fast-flash mode, then hold the button again for approx 5 seconds to change back to slow-flash mode

13. **Android only:** Ignore messages such as "Connected without internet" and tap **<** in the Android nav bar to ignore [p]

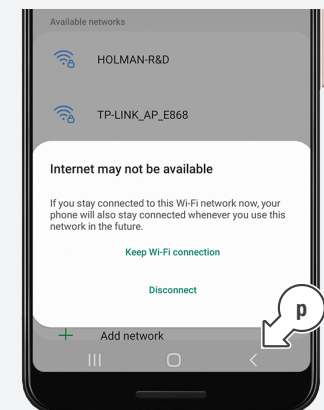

ADDING YOUR Wi-Fi HUB (Continued)

14. **Android only:** Once **Holman-WX-XXXX** is the active network, return to **Holman Home** using by tapping the multi-screen icon [q]

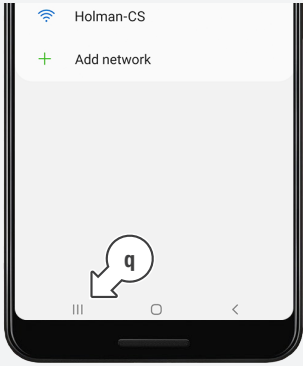

15. **iOS only:** Once **Holman-WX-XXXX** is the active network [r], return to **Holman Home** using by tapping the **Holman Home** shortcut [s]

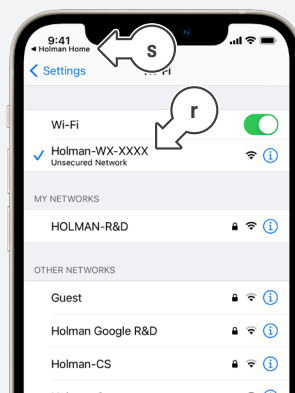

16. Wait while your **Wi-Fi Hub** is being added to **Holman Home** [t]

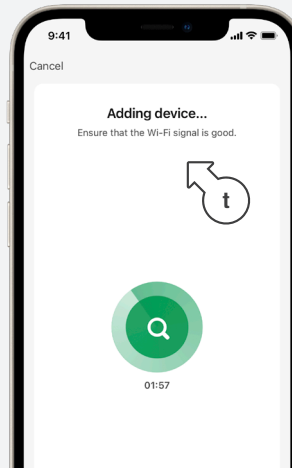

17. If your **Wi-Fi Hub** [u] connects successfully, tap **DONE** [v]

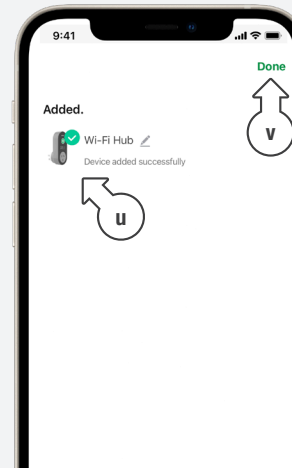

18. After confirming the connection, tap **ADD/VIEW DEVICES** [w] and follow the prompts to connect the **Wi-Fi Socket** and **WX1 Tap Timer**



- ⚠️ If this method of connecting the **WX1 Tap Timer** and **Wi-Fi Socket** does not work, tap the back button [x] to go back to the **HOME** screen, and follow the next set of instructions for an alternative connection method

ADDING YOUR WX1 TAP TIMER AND Wi-Fi SOCKET TO HOLMAN HOME

1. Ensure your **WX1 Tap Timer** is close to your router and install 4x 1.5v AA alkaline batteries [a]



2. From the **HOME** screen tap **+** [b] to add the **WX1 Tap Timer** and **Wi-Fi Socket**

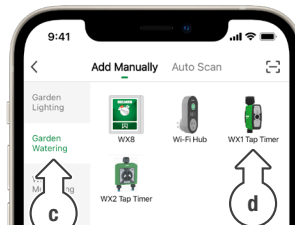
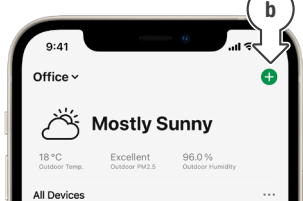

3. Tap **GARDEN WATERING** [c] and choose **WX1 Tap Timer** [d] When a **GATEWAY** [e] is requested, select **Wi-Fi HUB** [f]

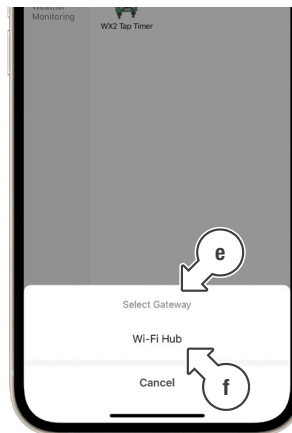

4. Reset the **WX1 Tap Timer** as per the instructions provided on-screen [g]
5. Once the **WX1 Tap Timer** is flashing accordingly, check the LED confirmation toggle [h] and tap **NEXT** [i]
- ⓘ If your **WX1 Tap Timer** fails to add to **Holman Home**, restart the app, and start the process again to add your **WX1 Tap Timer** and **Wi-Fi Socket**



6. Wait until both the **WX1 Tap Timer** [j] and **Wi-Fi Socket** [k] have been added, then tap **DONE** [l]

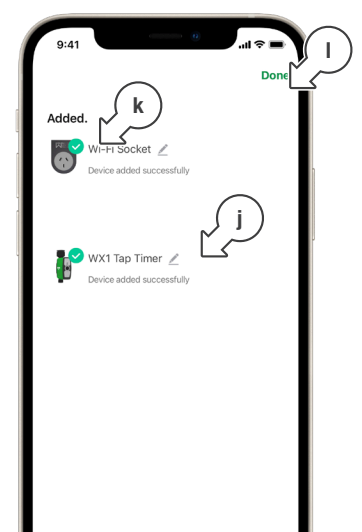

Need help? Just ask!

The Holman website has a host of additional information on features. Head to support.holmanindustries.com.au for more tips, tricks and support content.

If you still need help, feel free to email our friendly Customer Service team at support@holmanindustries.com.au or call at 08 9416 9999.



HOLMAN

For the #SMARTGARDENER



WX1 Setup Process Workaround

For additional help, visit <https://www.holmanindustries.com.au/>